

# AL20LP

**TELESCOPIC JIB  
20T CAPACITY**

HEIGHT OF  
195 MM  
HIGHER <  
PRODUCTIVITY

FREE TILTING FRAME  
AND BOOSTER  
SYSTEM

SMOOTH LIFTING  
MANAGEMENT

CAST PARTS  
FOR HIGH-STRESS  
AREAS



**> POWERFUL**

Unique tilting frame and boosters system to provide **unmatched lifting capacity**

Higher productivity thanks to the available space

**> CONVENIENT**

Ease of use thanks to the new **Ampli'Drive** hydraulics solution

**> VERSATILE**

**Lengths from 49 to 61** available and customization possibilities

**> ROBUST**

High quality strength steels

**AMPLIROLL® HIGH**



## OPTIONS AND ACCESSORIES



**Hooks selection**  
Heights & types



**Rear Hydraulic Locking**



**Front Hydraulic Boxes & Oiltank**



**Ampli'Drive Controls**  
• Fast speed  
• Sequence control



**Free Glide**  
• Frictionless drive

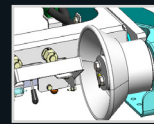

**Hydraulic bypass**



**Rear Underrun Protection**  
• Fixed • Telescopic  
• Panto • Inclined

Additional options & accessories available for customized configuration

## TECHNICAL DATA

For GVW from 26 T		S49	S51	S52	S53	S55	S56	S57	S58	S59	S61
	Min. container length (mm)	4 500	4 500	4 600	4 700	4 900	5 000	5 100	5 100	5 200	5 200
	Max. container length (mm)	6 100	6 300	6 400	6 500	6 700	6 800	6 900	7 000	7 100	7 300
	Container length with fixed RUP (mm)	5 100	5 300	5 400	5 500	5 700	5 800	5 900	6 000	6 100	6 300
	Weight (kg)	2 167	2 197	2 244	2 259	2 310	2 358	2 373	2 410	2 430	2 460

Subject to technical modification; data not binding.  
Depending on the market. Chassis recommended.

AMPLIROLL® HIGH

